

PROPOSED CREATIVE PLAY AREA

- TIRE SWING
- CLIMBING TREES
- CIRCULAR SLIDE
- GRASS
- P.P. TIE EDGING
- "GRITS"-TYPE IA STONE
- CABLE BRIDGE
- HORIZONTAL LADDER
- TUNNEL SLIDE
- HANDICAPPED RAMPS
- SWINGING PLATFORM
- HANDICAP ACCESS

- AMPHITHEATRE
- CASTLE
- DOUBLE SLIDE
- MAZE
- PICNIC TABLES
- BUMPY TUNNEL SLIDE
- RUBBER BRIDGE
- BOUNCER
- ALLIGATOR

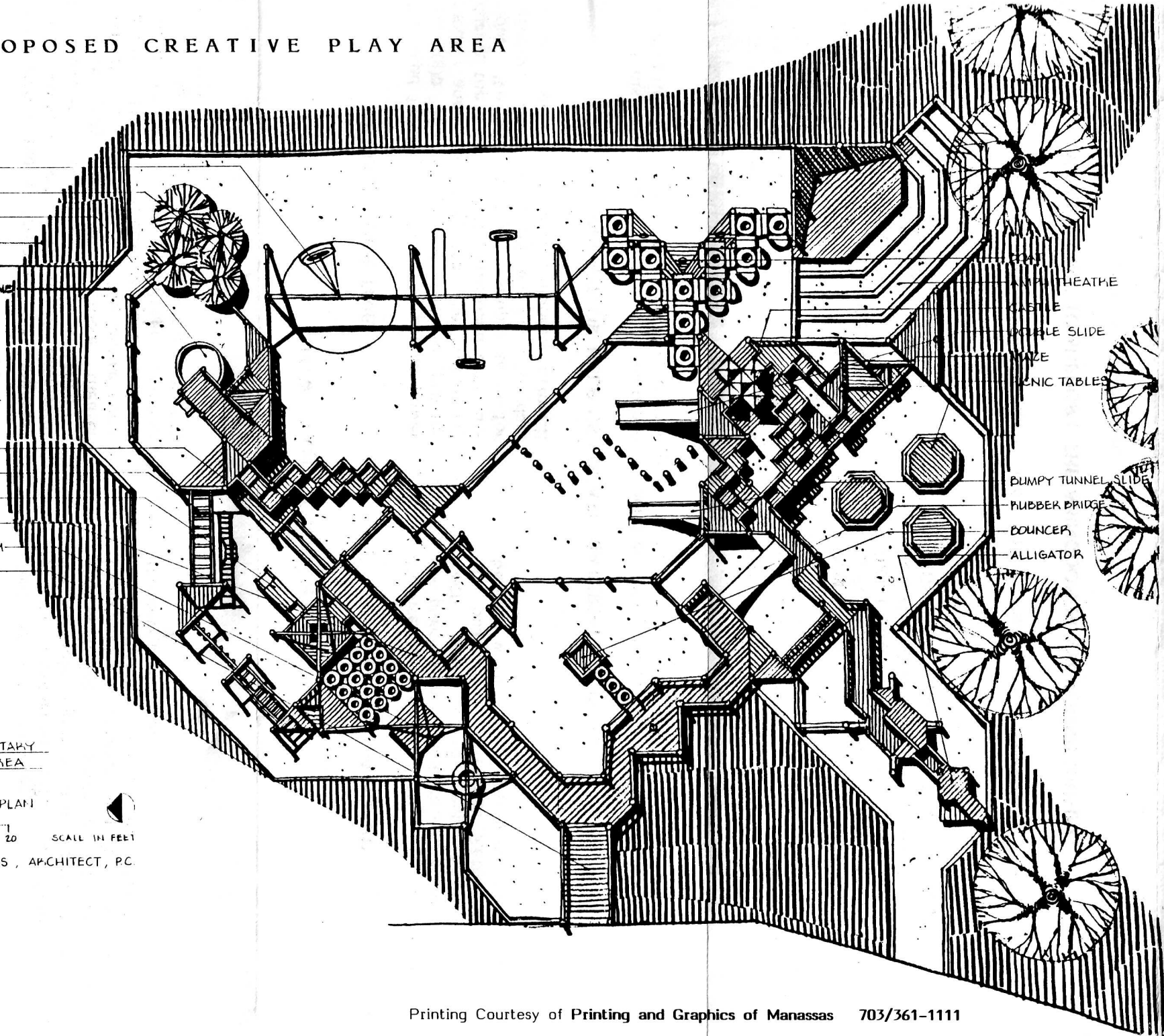

ABINGDON ELEMENTARY
CREATIVE PLAY AREA

SCHEMATIC SITE PLAN
0 5 10 20 SCALE IN FEET

ROBERT S. LEATHERS, ARCHITECT, P.C.

31 OCTOBER 1984

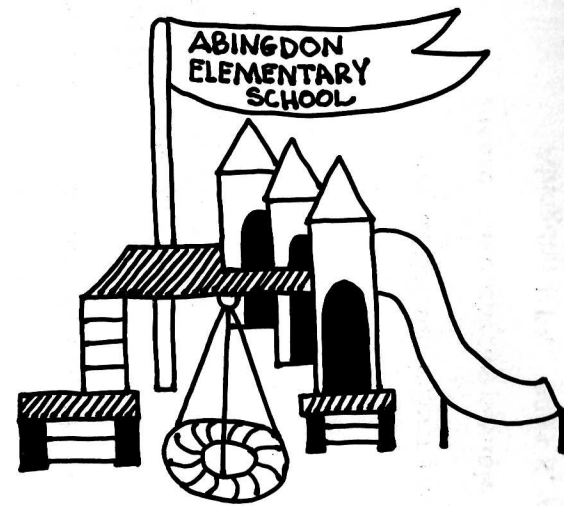

COMMUNITY
PLAYGROUND RAISING

APRIL 18, 19, 20, 21

Building Together...

A Special Place to Play

WHAT WE ARE DOING

A NEW PLAYGROUND

The parents and children of our neighborhood, working with the noted architect, Mr. Robert Leathers, have designed a creative play area and outdoor theater that will be available to the entire community. This ambitious project includes equipment that will challenge children of all ages, and special facilities for the handicapped.

A "PLAYGROUND RAISING"

Just as our forebearers joined together in the community effort of barnraisings, we will join together in a community "Playground Raising." Over a four-day period (April 18-21) parents, children, and community members will join together to create the new play area.

HOW YOU CAN HELP

DONATE YOUR TIME

We need hundreds of hours of people power to build the playground and to provide meals and childcare for the volunteers during the four days of playground construction. We have plenty of simple tasks for unskilled workers. Spend an hour, a day, or the weekend on this community effort!!!

BUY-A-BOARD

Donate a tax-deductible gift to be used for purchasing needed materials and services. Each 2x4x8 board costs \$3.00. Donate one board or a trainload. Return the form below with your tax-deductible check.

DONATE OR HELP US LOCATE MATERIALS AND TOOLS

Your tools will make it possible for volunteers to build our playground! We also need help in obtaining construction materials. Can you donate or help us locate the following:

MATERIALS NEEDED

#1 GRADE LUMBER
CONVEYOR BELT
CONCRETE
KEROSENE
SANDPAPER (LOTS)
STONE (TYPE 1A)
GALVANIZED STEEL CABLE
MISCELLANEOUS HARDWARE

NAILS
BOLTS
NUTS
CHAIN
WASHERS
TREES/SHRUBS

TOOLS NEEDED

CHAIN SAWS
CIRCULAR SAWS
STORAGE VAN
WRENCHES
POWER DRILLS
ELECTRIC SANDERS
DRILL AND ROUTER BITS
BOB CAT (Small bucket loader)
HIGH WATTAGE EMERGENCY LIGHTS

SHOVELS
SAW HORSES
PAINT BRUSHES
RAKES
PICK-UP TRUCK
WHEELBARROWS

-----Please detach and return this form-----

YES!!! I WANT TO SUPPORT THE ABINGDON PLAYGROUND RAISING

- I can help during the construction weekend.
- I can donate or help to locate the following tools and materials:

Enclosed is my tax-deductible contribution to purchase:

- () one board, \$3.00
() an armful of boards, \$15.00
() a wagonload of boards, \$30.00
- () a truckload of boards, \$60.00
() a trainload of boards, \$100.00
() Other: _____

Name of donor: _____ Phone: _____
Address: _____

For additional information, call Barbara Effron at 931-6186.

Please make checks payable to "Abingdon PTA." Mail this form to:

Abingdon PTA, 3035 S. Abingdon St., Arlington, VA 22206.

JOIN US FOR



**Our Community
Playground Raising**

Date: Thursday, April 18 through
Sunday, April 21

Time: 7:30 a.m. 'til dark

Place: Abingdon School

RSVP: Barbara Effron, 931-6186

Join your neighbors in a spirit of adventure, fun and camaraderie to build a creative play area and amphitheater for our community. This ambitious project includes equipment that will delight and challenge children of all ages.

We need hundreds of hours of people-power to:

- BUILD the playground
- Provide CHILDCARE
- Provide MEALS

We have plenty of simple tasks for unskilled workers. No prior experience is required, just an interest in having fun.

Donate an hour, a day, or the weekend for this great community project!!

- Look inside for a complete list of fun activities. ●

The printing of this brochure was sponsored by FAIRLINGTON PROPERTIES, INC. ● 4800 S. 31st St. ● Arlington, VA 22206 ● 998-3111

Abingdon PTA
3035 S. Abingdon Street
Arlington, VA 22206

Please fold this brochure to letter size, tape closed (or place in envelope) and return to:



**COMMUNITY
PLAYGROUND RAISING**

APRIL 18, 19, 20, 21

PLEASE CHECK EACH AREA IN WHICH YOU CAN HELP.

BUILDING THE PLAYGROUND

- I can help as an unskilled worker.
- I can help as a skilled worker.
(Persons who can cut a straight line with a hand-held circular saw)
- I need childcare while I volunteer.
Please list names and ages of children needing care:

PLEASE PLACE THE FIRST NAME OF EACH VOLUNTEER IN THE TIMES YOU CAN BUILD.				
	Thursday April 18	Friday April 19	Saturday April 20	Sunday April 21
Shift #1 7:30 a.m.-Noon				
Shift #2 Noon-4 p.m.				
Shift #3 4 p.m.-Dark				

CHILDCARE

Childcare at Abingdon for ages 3-13:

- I can assist with childcare.
- I have a talent to share in:
 - ___ music ___ arts/crafts
 - ___ sports ___ storytelling/
 - ___ other ___ puppets
- I can donate the following materials:
 - ___ paper ___ games ___ toys
 - ___ crayons/markers ___ VCR

Childcare in private homes:

- I can provide childcare in my home for children under 3.

FOOD

- I will bring the food items listed below, serving 6-8 people.
 - ___ casserole ___ baked goods
 - ___ salad ___ snacks
 - ___ paper products ___ other
- I can help pick up donated foods.
- I will assist in serving and setting up foods for meals and snacks.

TOOLS

I can loan the tools checked on the list below. (If you have more than one, please indicate the quantity.) All tools will be labeled, inventoried, and locked up at night. Any damaged or lost tools will be repaired or replaced. The Tools Committee will notify you when and where to deliver the tools. For more information, call Peter Wyckoff at 578-3633.

- | | | | |
|--|----------------------------------|-----------------|----------------------|
| ___ 100' tape measure | ___ extension cord(25' or more) | ___ crow bar | ___ carpentry hammer |
| ___ 10'-25' tape measure | ___ handtamp(small and large) | ___ pickax | ___ sledge hammer |
| ___ chain saw (heavy duty) | ___ 6' metal straight edge | ___ nail set | ___ 4' digging bar |
| ___ brace with expansion bit | ___ 12" power mitre box | ___ pipe vise | ___ 18" bolt cutter |
| ___ carpenter's protractor | ___ garden rake (not leaf) | ___ pipe cutter | ___ push-brooms |
| ___ 20' tow chain (with hooks) | ___ router (3/8" corner-rnd bit) | ___ wood rasp | ___ scrub brush |
| ___ chain saw sharpener | ___ circular saw(heavy duty) | ___ belt sander | ___ C-clamps (large) |
| ___ chalk line and bottle | ___ radial arm saw(heavy duty) | ___ disc sander | ___ 5-gal. gas can |
| ___ cold chisel and steel plate | ___ 12" combination square | ___ sabre saw | ___ 8"-10" cat's paw |
| ___ heavy duty come-along | ___ 2' framing square | ___ table saw | ___ safety goggles |
| ___ cordless 1/4" or 3/8" drill | ___ adjustable crescent wrench | ___ sawhorse | ___ 1 5/8" holesaw |
| ___ 1/4" heavy duty reversible drill | ___ set of ratchet wrenches | ___ spade | ___ 4 1/2" holesaw |
| ___ 1/2" heavy duty reversible drill | ___ stepladder(6'-8') | ___ hack saw | ___ level(18" min.) |
| ___ drop lights & extension cords | ___ stepladder(10'-12') | ___ hand saw | ___ pick-up truck |
| ___ electric gang cord(6' or 10') | ___ post-hole digger | ___ vise grip | ___ bevel square |
| ___ wrench (electric impact, 9/16" socket) | ___ garden hose | ___ wheelbarrow | ___ utility knife |
| ___ wood chisel (1/4"-1 1/2") | | | |

Name(s) of volunteer(s) _____ Phone number _____

Address _____

- I am unable to participate, but I'm enclosing a tax deductible contribution. (Please make checks payable to "Abingdon PTA.")

General questions/information - call Barbara Efron at 931-6186.

PLEASE RETURN THIS FORM TO: Abingdon School, 3035 S. Abingdon St., Arlington, VA 22206

THANK YOU FOR YOUR COMMUNITY SPIRIT!